

HSF

NOTES:
 Rated Current:3.0A
 Rated Voltage:250V AC/DC
 Contact Resistance:20mΩ max
 Withstand Voltage:1000V AC/Minute
 Insulation Resistance:1000MΩ min
 Operation Temperature:-25℃ to +85℃

Contact Material:Brass
 Contact plating:Au Or Sn Over Ni
 Insulator Material:PBT+30%G.F (UL94V-0)

Recommended P.C.B Layout(Top Side)
 (PCB BOARD TOLERANCE±0.05)

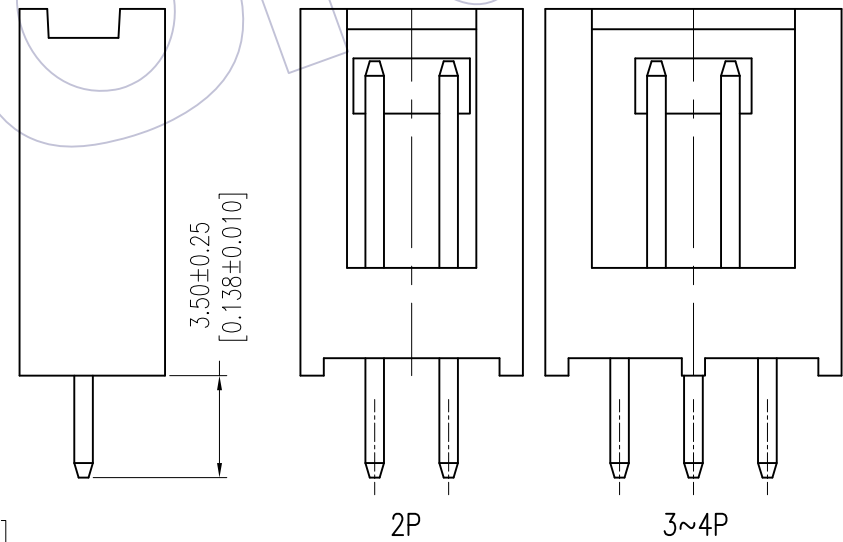
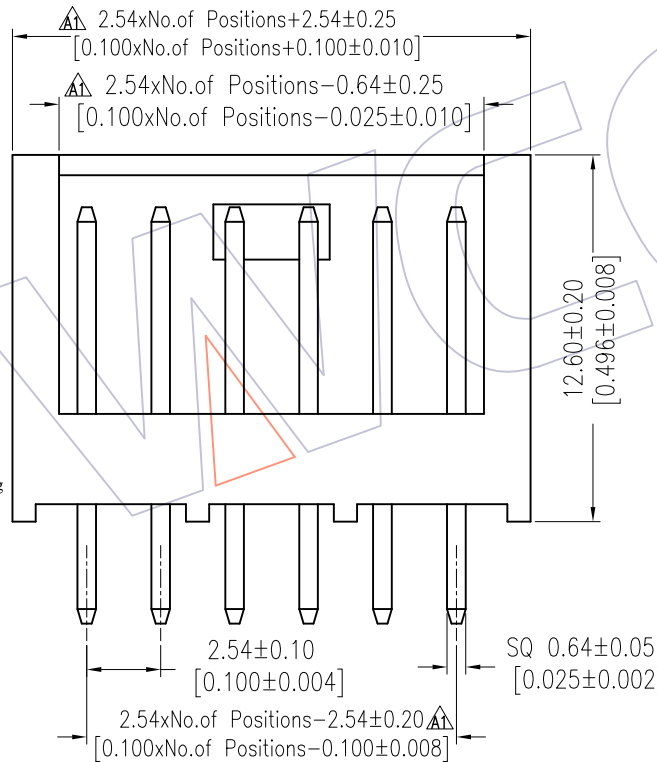
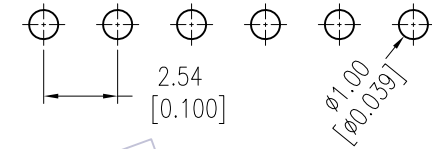
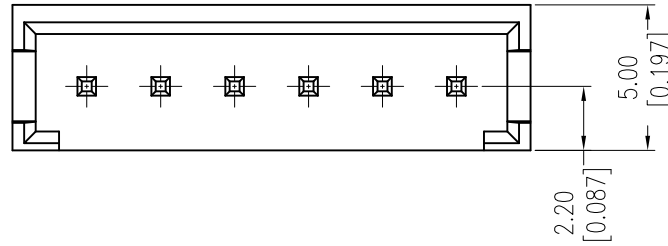

Ordering Information

WF2548 -1 WS XX X 0 1

No.of Row Single Row
 No.of pins 02P~22P
 Contact Plating S0=Gold Flash/Tin S3=10u"Gold/Tin S4=15u"Gold/Tin S5=30u"Gold/Tin G0=Gold Flash G3=10u"Gold G4=15u"Gold G5=30u"Gold Blank=Tin
 Color B=Black W=White
 Packing 0=PE Bag T=Tube

5P及以上

REV	DATE	MODIFICATION DESCRIPTION	CHANGE	OPERATION		DRAW Ding	DATE 2017/02/28	SCALE	FIT	PART NO. WF2548-1WSXXX01
				X.X	±0.40			UNIT	mm inch	
A1	2017/02/28	Modify	△	X.XX	±0.25	CHECK	DATE	SIZE	A4	TITLE: 2.54 SINGLE ROW 180° DIP WAFER
A0	2012/09/08	NEW	—	X.XXX	±0.15	APPROVE	DATE	SHEET	1/1	Customer NO.
				Angle	± 3'			PROJ.		

WCON

Http: www.wcon.com

WCON-Dongguan Tel: +86 769 85358920 Fax: +86 769 85358915 E-mail: sales@wcon.com
 WCON-Kunshan Tel: +86 512 57468408 Fax: +86 512 57468468 E-mail: salesks@wcon.com